

Central Shared Use Facility Silver Spring Maryland

General Information

Size: 11,695 sq. meters

3 stories, 1 basement

Cost: \$24,241,000 Lump Sum Contract

Construction Dates: 10/05/04 - 3/29/06

Site: Old Navel Research Center

Project Team

Owner: U.S. General Services Administration

Occupant: Food and Drug Administration

Architect/Design: Kling Lindquist

General Contractor: Centrex Construction

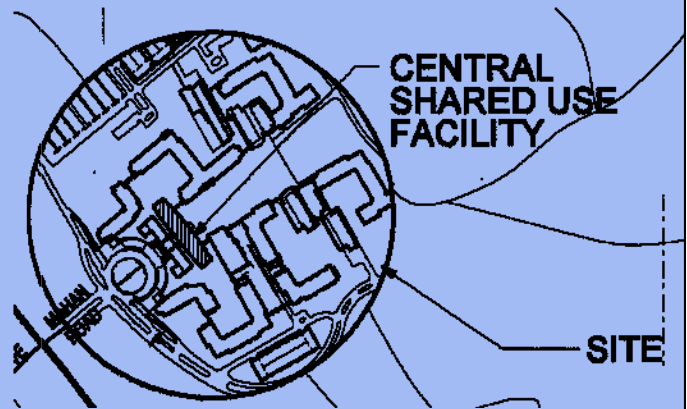

Lighting/Electrical

- The transformers are 480V Delta and 208/120 wye.
- Power is generated by natural gas turbines at a CUP; backup power is supplied by PEPCO.
- The lighting is mainly fluorescent.

Mechanical

- Central Chiller/Boiler plant provides cold/hot water to the building
- 7 AHU's supply and distribute conditioned air.
- VAV boxes control airflow throughout building
- Plenum return system

Structural

- Post Tensioned Concrete used for slab and column construction
- Spread Footings used to support the structure.



**Jonathan Burke
Mechanical**

<http://www.arche.psu.edu/thesis/eportfolio/current/portfolios/jsb275>