portfolio

anne k cheney

lighting | electrical

original photography

left | chicago

right | scotland

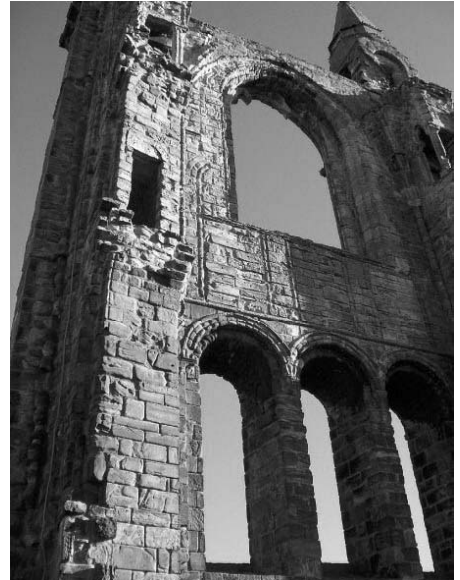

original photography

left | amsterdam

right | florence



original photography

left | venice

right | milwaukee



original photography

vatican city



original photography

left | leeds
right | madrid



autodesk viz

single family home rendering
micro cadd applications for buildings



autodesk revit

single family home rendering
micro cadd applications for buildings



3d autocad

single family home rendering
micro cadd applications for buildings

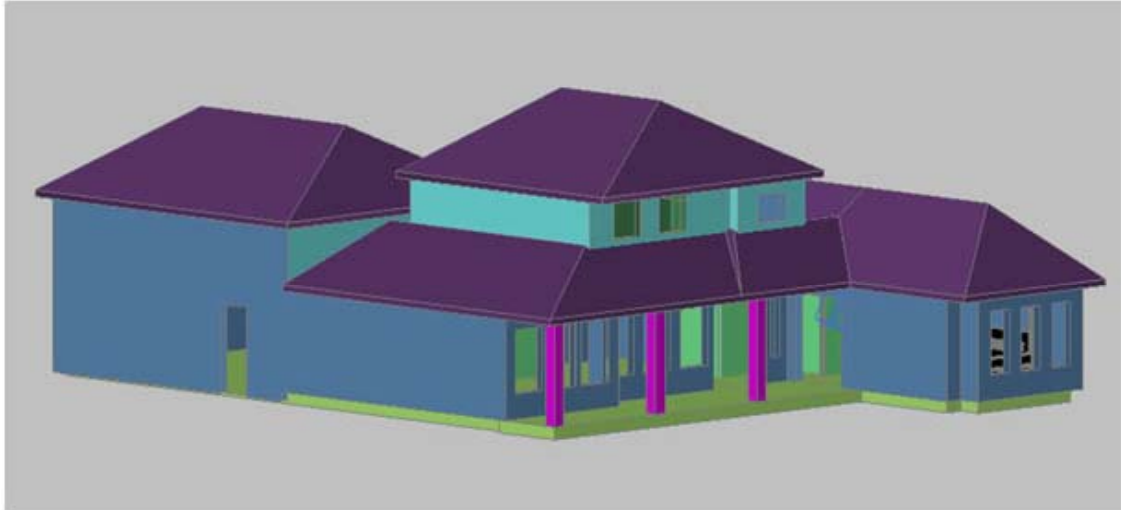

google sketch-up

mixed-use apartment building design
architectural studio



google sketch-up

mixed-use apartment building design
architectural studio



google sketch-up

building connection re-design
university of leeds



flynn mode study

relaxation vs tension
sketches

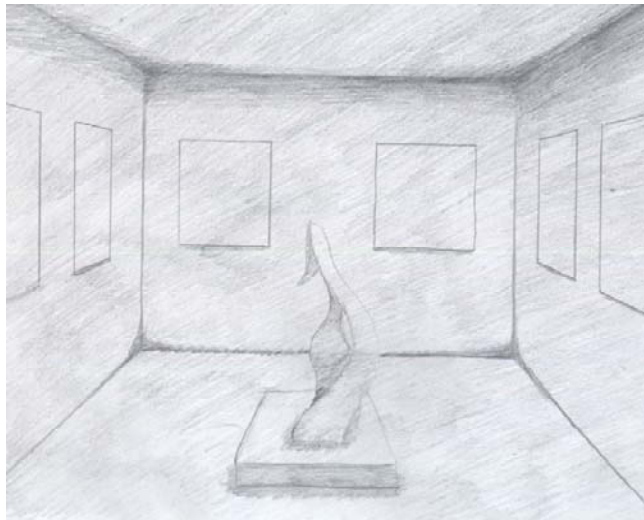
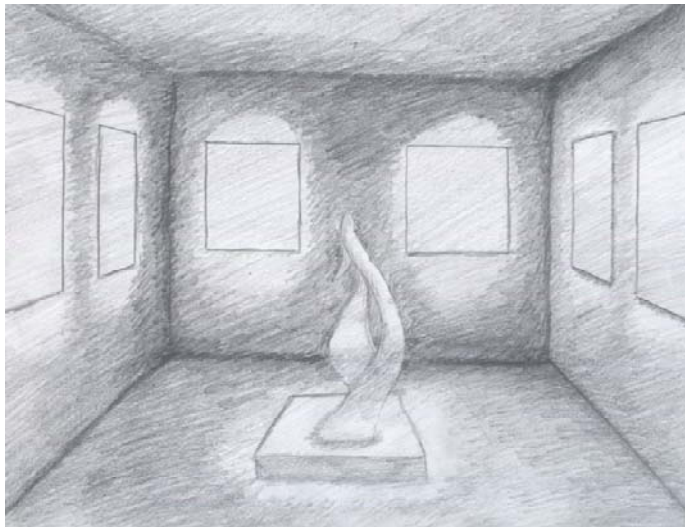

flynn mode study

relaxation vs tension
model set-up

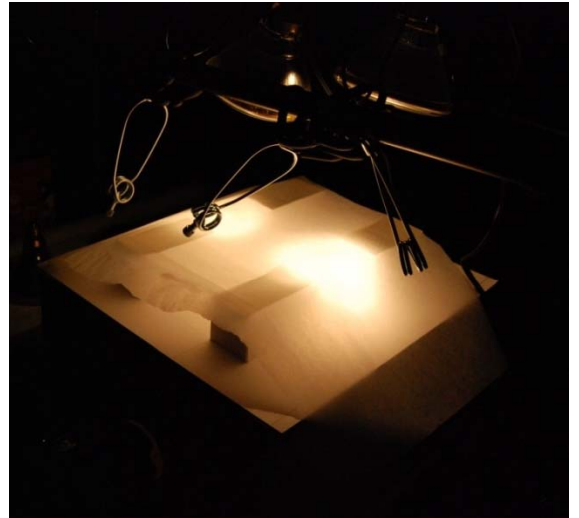

flynn mode study

relaxation vs tension

1" = 1'-0" scale model



flynn mode study

relaxation vs tension
agi32 model



original artwork

cd artwork
the fever dream

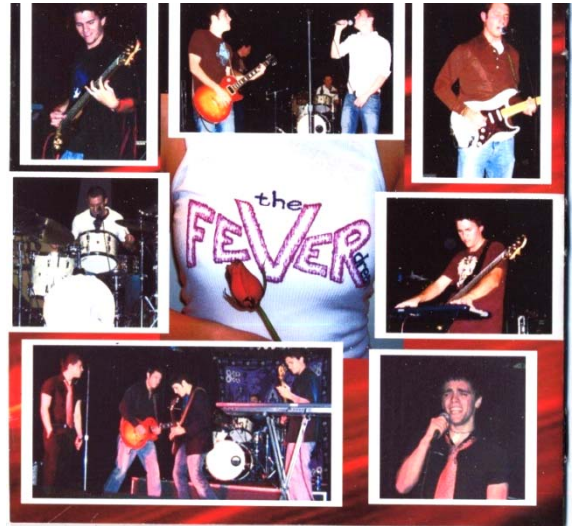
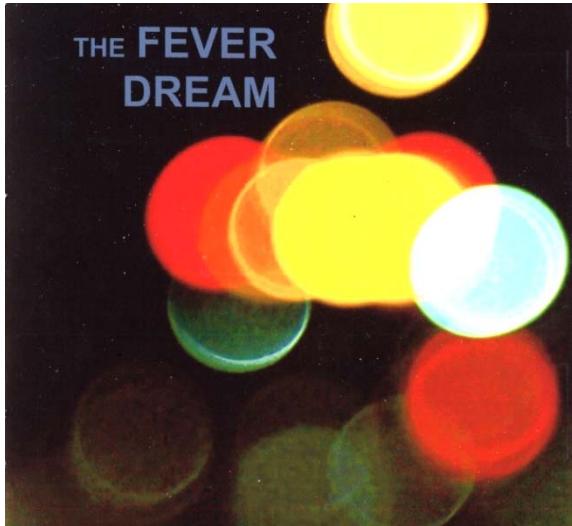

original artwork

cd artwork

the fever dream

Jeremy Moore

Instrument: Lead Vocals

Influences: Rush, Muse, Led Zeppelin, and The Flaming Lips.

"You just gotta take life as it comes, and be spontaneous sometimes."



Alex Giovanelli

Instruments: Guitar and Keyboard

Influences: The Beatles, Radiohead, Weezer, Fountains of Wayne, Led Zeppelin, Green Day, and The Strokes.

"I love fruit smoothies and peanut butter and Chinese food."



Chris Alvarado

Instrument: Drums

Influences: Tool, The Mars Volta, Clutch, latin music, my father, and my older brother.

"I love listening to music and playing the drums & sports."



Greg Kester

Instrument: Guitar and Vocals

Influences: Mainly John Frusciante, Andy Summers, Jimi Hendrix, Mike Einziger, Tom Petty, and Martin Barre.

"Music completely revitalizes me, and I hope I get the chance to continue to pursue it throughout my life."



Matt Ullestad

Instruments: Bass and Keyboard

Influences: Rush, Yes, Dream Theater, Metallica, Tool, Joe Satriani, Billy Sheehan, and Tony Levin

"I firmly believe that Geddy Lee and Alex Lifeson are the coolest mosos ever to rock the lighted stage. And I wish Neil Peart was actually one of my professors."



original artwork

watercolor



original artwork



pastels



original artwork



colored pencil sketches



original artwork

pencil sketches



agi32 rendering

howard brandston lighting competition
computer aided lighting design



HOWARD BRANDSTON STUDENT GRANT 2008

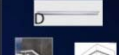
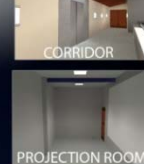

Room	Area (sq ft)	Lighting Type	Quantity	Wattage	Notes
LAB	1000	Recessed	10	100W	Linear lighting
LAB	1000	Recessed	10	100W	Linear lighting
LAB	1000	Recessed	10	100W	Linear lighting
LAB	1000	Recessed	10	100W	Linear lighting
LAB	1000	Recessed	10	100W	Linear lighting
LAB	1000	Recessed	10	100W	Linear lighting
LAB	1000	Recessed	10	100W	Linear lighting
LAB	1000	Recessed	10	100W	Linear lighting
LAB	1000	Recessed	10	100W	Linear lighting
LAB	1000	Recessed	10	100W	Linear lighting



agi32 rendering

wall grazing study
computer aided lighting design

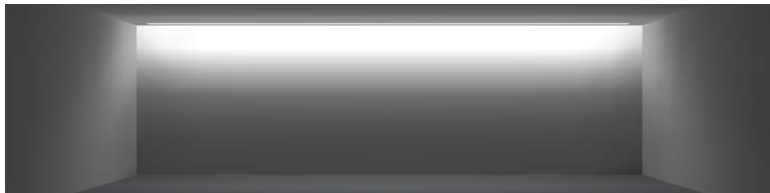
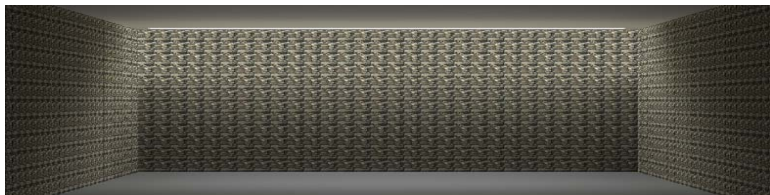
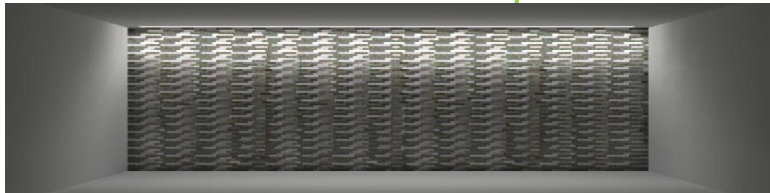

agi32 rendering

conference room study
computer aided lighting design



photoshop

schematic design
ae senior thesis

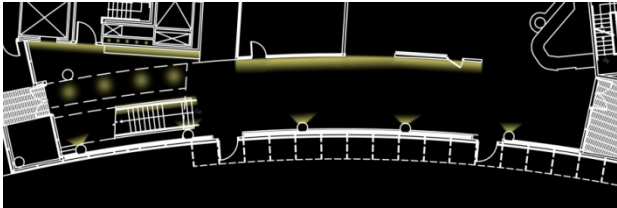

agi32 rendering

design development
ae senior thesis



photoshop

schematic design
ae senior thesis

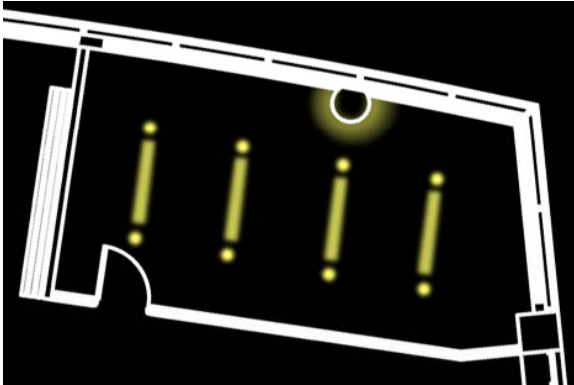

agi32 rendering

design development
ae senior thesis



photoshop

schematic design
ae senior thesis

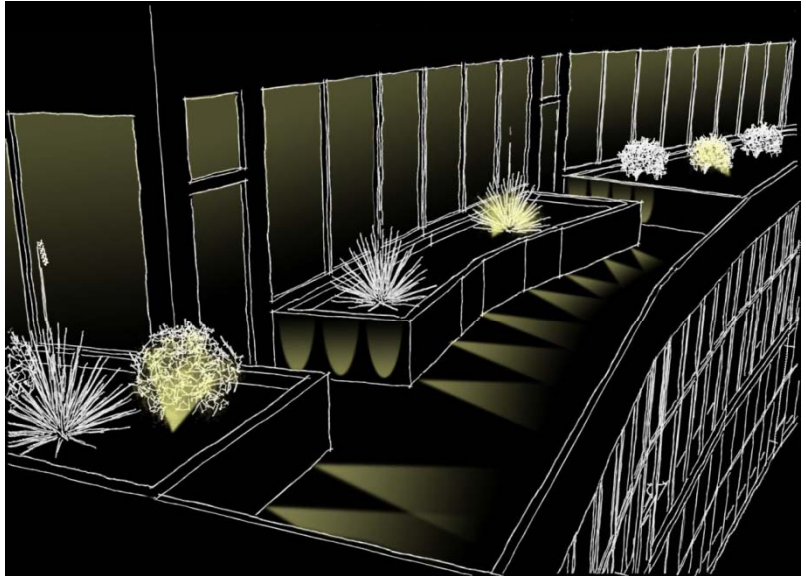
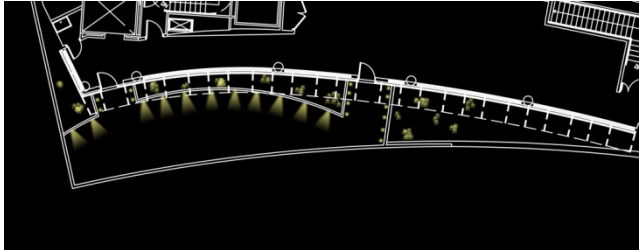

agi32 rendering

design development
ae senior thesis



photoshop

schematic design
ae senior thesis

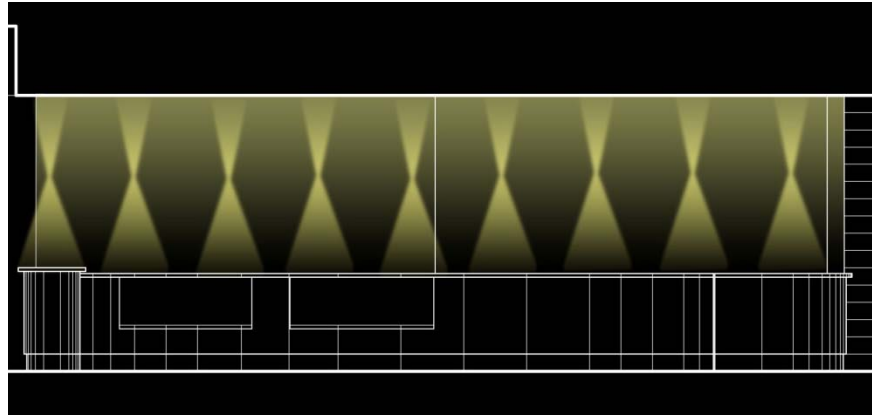
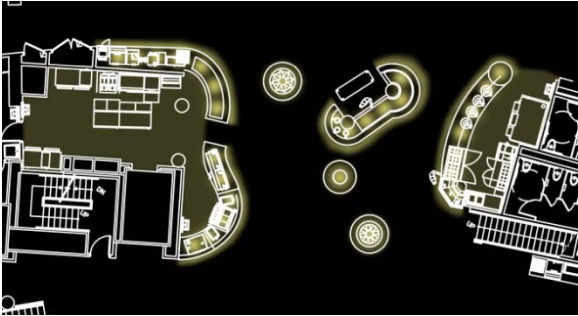

agi32 rendering

design development
ae senior thesis



photoshop

façade light study

h1b lighting design internship



photoshop

façade night-time rendering
computer aided lighting design



photoshop

logo design

swe region g conference 2008

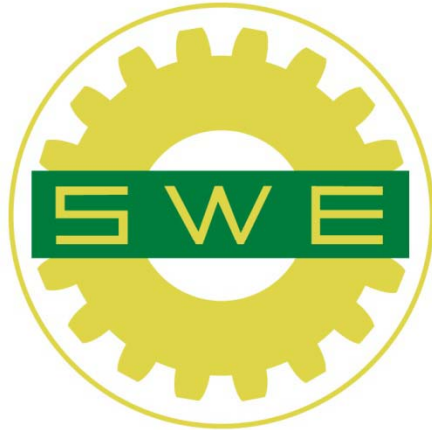

outdoor lighting

nittany lights
“whimsical” theme



outdoor lighting

nittany lights
“whimsical” theme

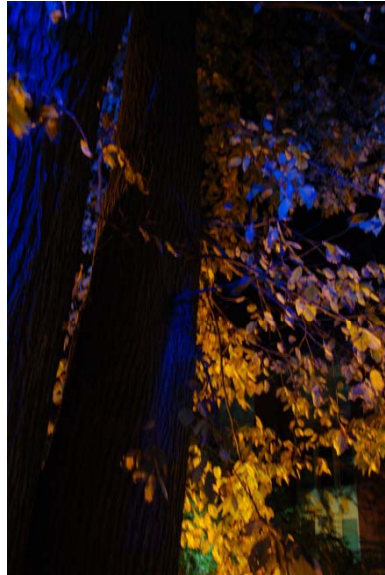
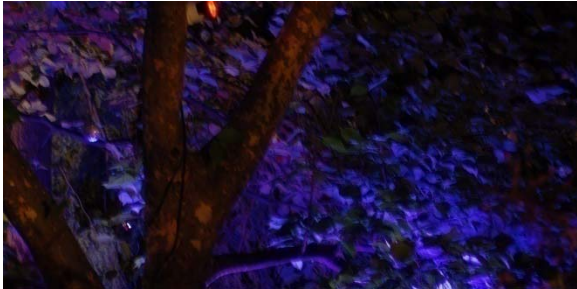



contact information



anne.cheney@gmail.com
215.407.1266