

Pershing Hill Elementary School Fort Meade, MD



Project Team and Building Information

Owner: Anne Arundel County Public Schools

Tenant: Pershing Hill Elementary School

Architect: Grimm and Parker Associates

Construction Manager: Jacobs

Construction Costs: \$13,311,664

Estimated Completion: Feb. 2011

Total size: 87,160 sqft



Construction

- ◇ Multiple prime with 15 prime contractors
- ◇ Complete demolition of existing building
- ◇ Project site lies entirely within a US Army Base

Electrical System

- ◇ 277/480V and 120/208V distribution
- ◇ Emergency Intercom available in each classroom

Site

- ◇ A portion of the project site falls within a critical wetlands area

Architectural

- ◇ Multiple Colors of decorative brick
- ◇ Curved aluminum canopy marks main entrance

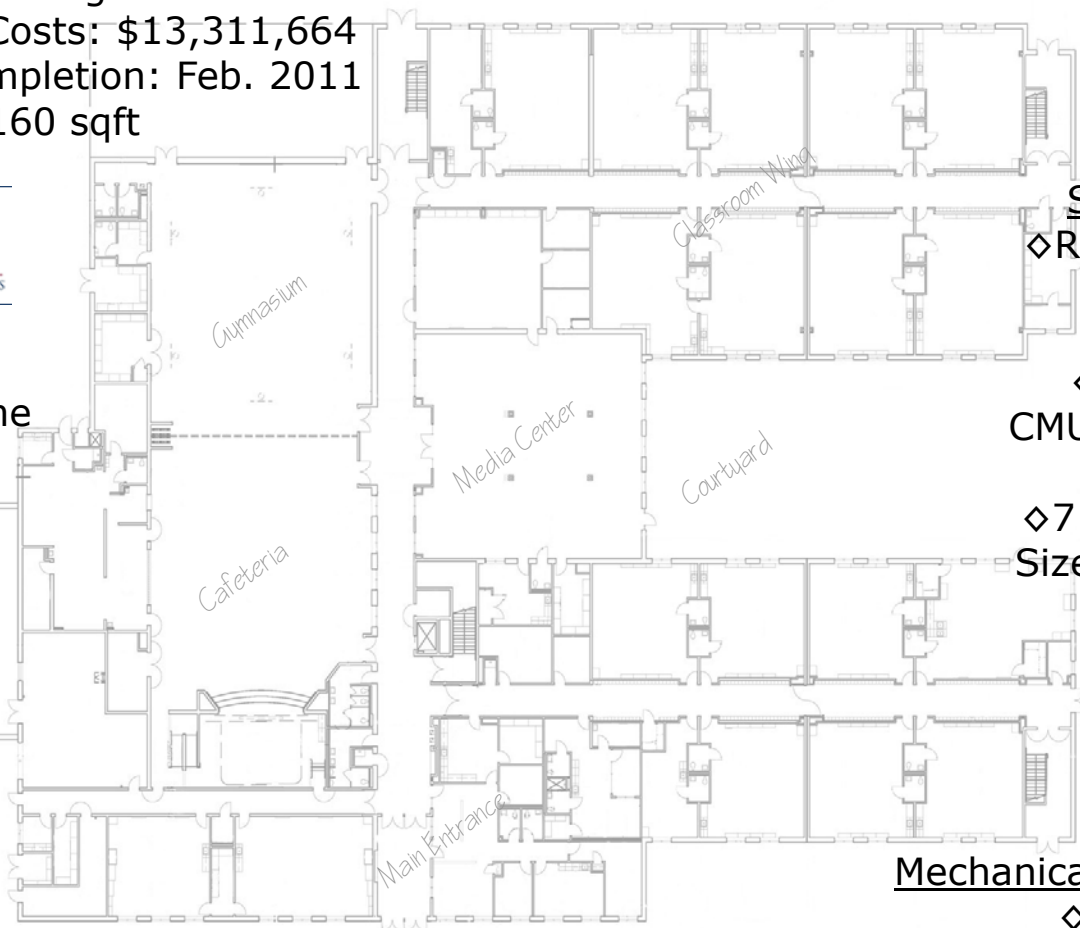

Structural

- ◇ Reinforced Concrete Footings
- ◇ Grouted CMU exterior walls
- ◇ 7 Different Sizes of HSS shaped columns
- ◇ Steel Joists and deck

Mechanical System

- ◇ 2 Boilers
- ◇ 11 Building Zones
- ◇ 46 Fan Coil Units
- ◇ 6 Ductless Split System Units
- ◇ 6 Rooftop Air Handling Units
- ◇ 2 Rooftop Air Handling Units with Energy Recovery

Mitchell Reiners Construction Management Option

<http://www.engr.psu.edu/ae/thesis/portfolios/2010/mrr5025/index.html>