

The Sterling and Francine Clark Art Institute

Asher Harder

THE CLARK

Building Concept Spaces

Facility Use: Utility Plant and Visitor, Exhibition and Conference Center

Size: 78,800 SF

Stories: 2 | 1 above grade

Architectural Summary

- Simple, clean lines with emphasis on vertical surfaces
- Open spaces inviting in the exterior environment
- Simple material palette



The Architect: Tadao Ando

“Known for producing serene interior spaces that invite contemplation...”
- clarkart.edu

Extensive use of natural light

Q: Describe your style...

A: Walls are the most basic elements of architecture ... light is an important factor... create a place for the individual, a zone for oneself within society
- designboom.com



THE CLARK

Building **Concept** Spaces

The Architecture

- Materiality
- Tactility
- Emptiness

Complex, three dimensional
circulatory patterns



ArchitectureWeek.com

THE CLARK

Building **Concept** Spaces

The Art: Impressionism

- Play of light and color
- Capture light and atmosphere at the cost of details

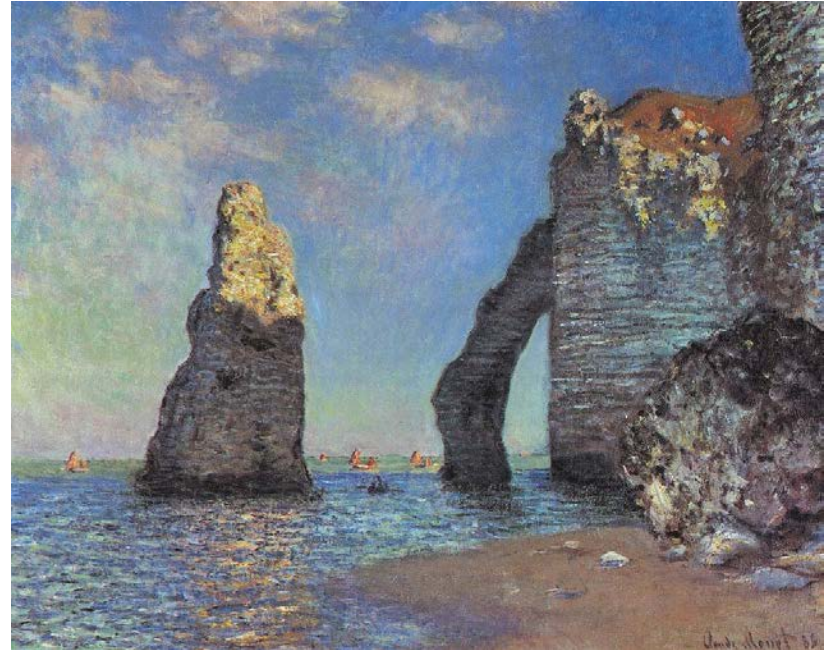

Claude Monet, The Cliff at Étretat after the Storm, 1885

Resolutions

- Respect the natural light in the space
- Enhance the “materiality, tactility, and emptiness of the walls”
- Use light to guide occupants through Ando’s circulatory paths within the space

THE CLARK

Building Concept **Spaces**

Criteria

- Support the seasonal atmosphere of the space
- Highlight architectural features
- Reduce light trespass
- Reduce skyglow
- Control glare
- Remain consistent to overall design concepts



Terrace Lobby Shop Multi-Use

THE CLARK

Building Concept Spaces

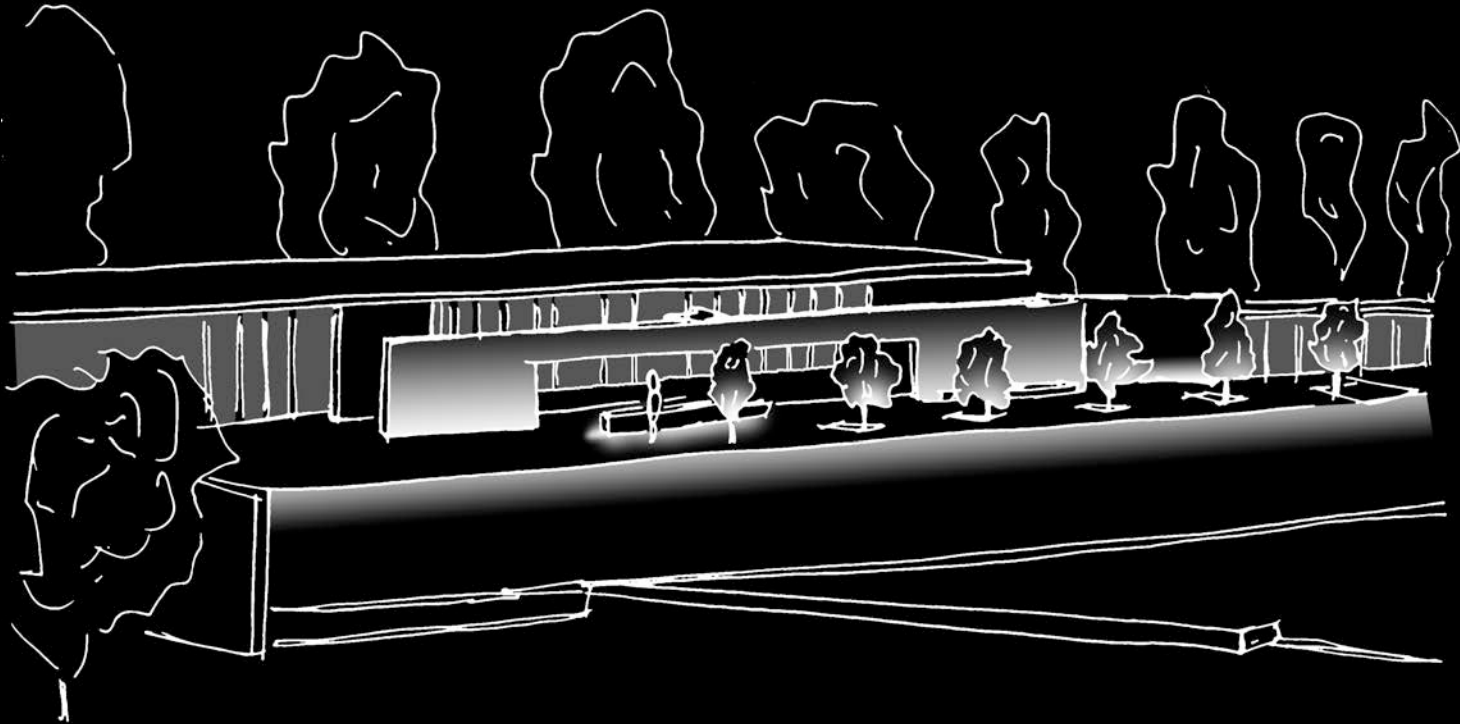

Terrace

Lobby

Shop

Multi-Use

THE CLARK

Building Concept **Spaces**

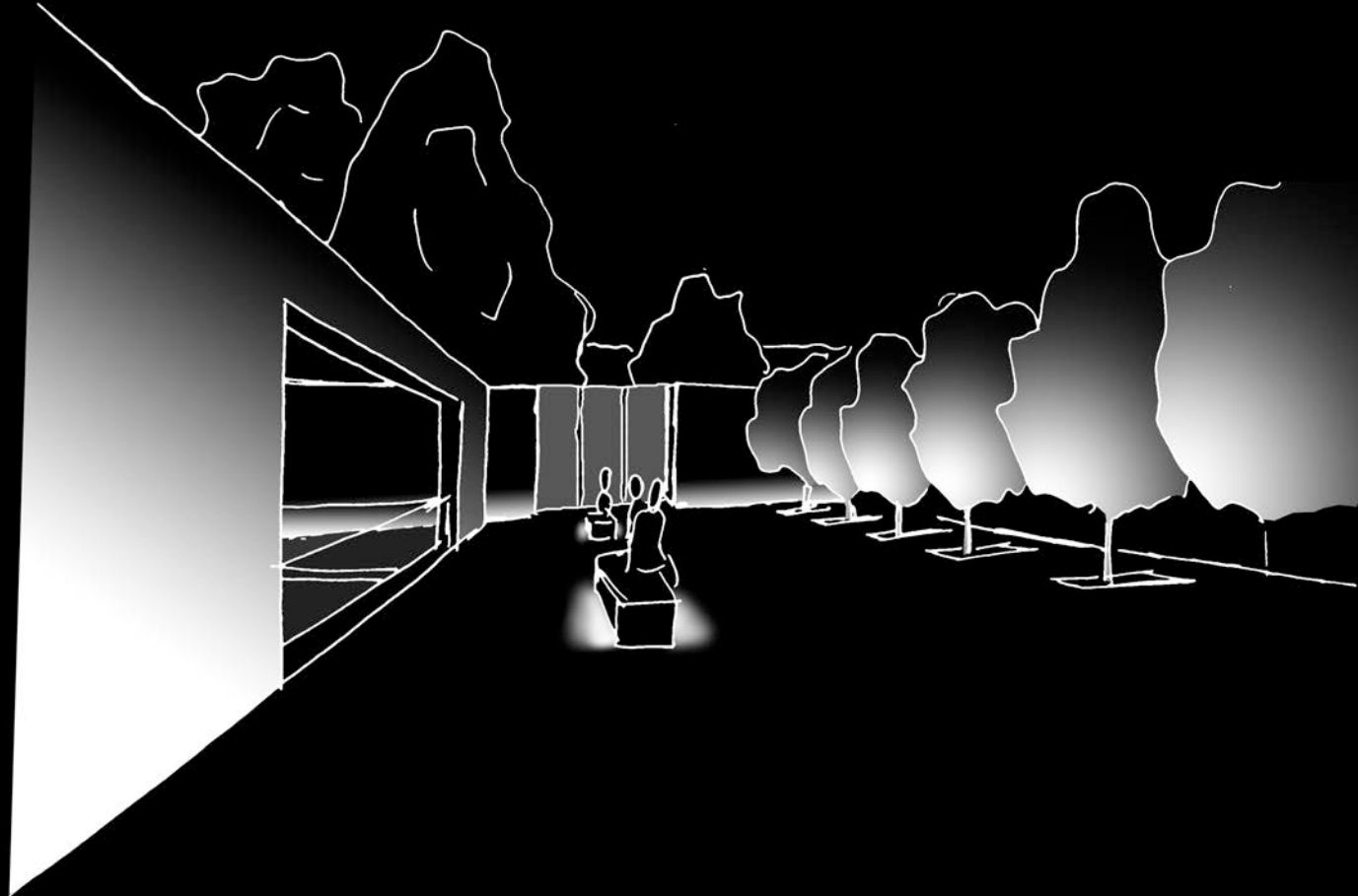

Terrace

Lobby

Shop

Multi-Use

THE CLARK

Criteria

- Create an impression of a public space
- Highlight architectural features
- Provide appropriate light for way finding
- Reduce light trespass
- Control glare
- Remain consistent to overall design concepts



THE CLARK

Building Concept **Spaces**

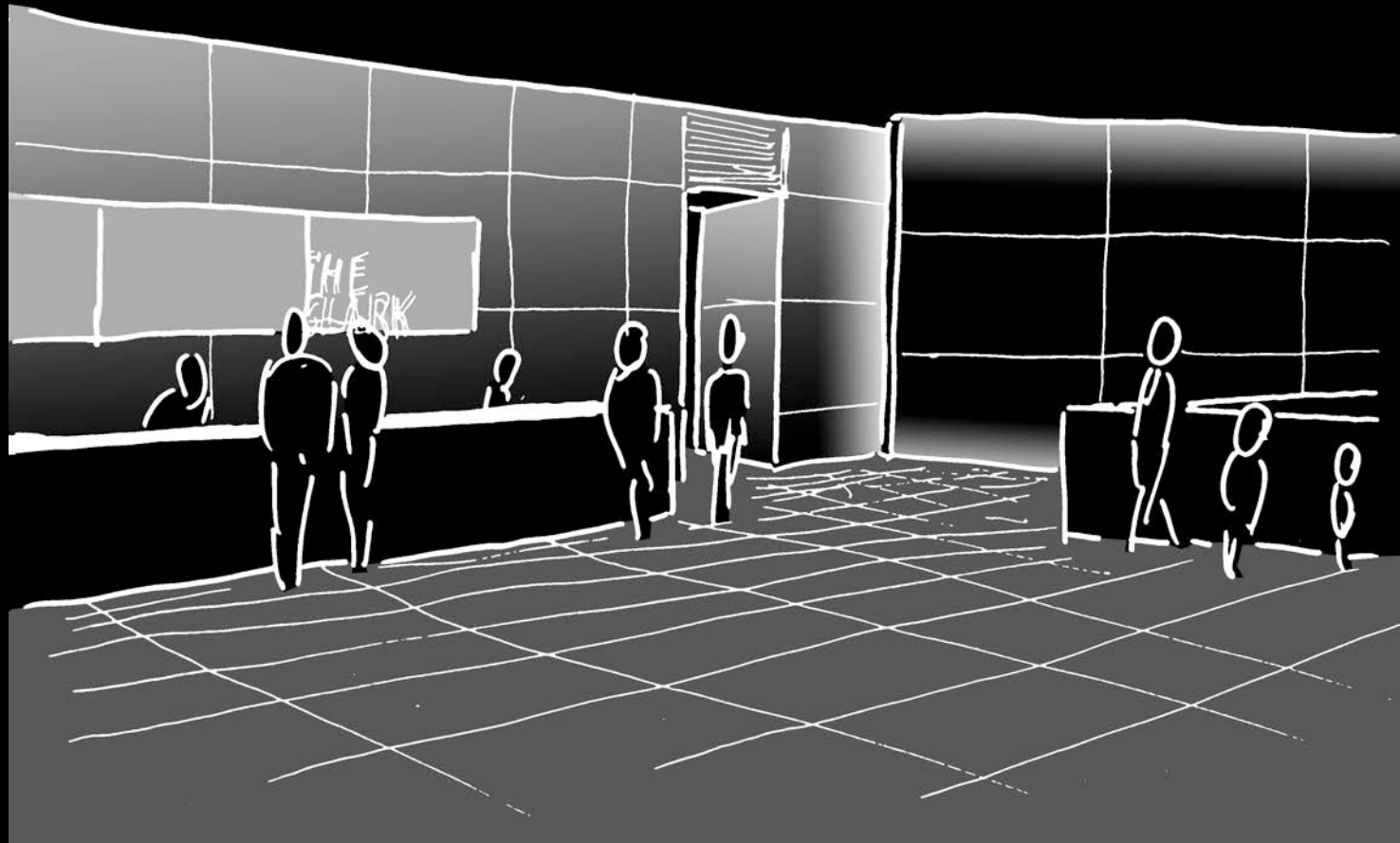

Terrace

Lobby

Shop

Multi-Use

THE CLARK

Building Concept **Spaces**

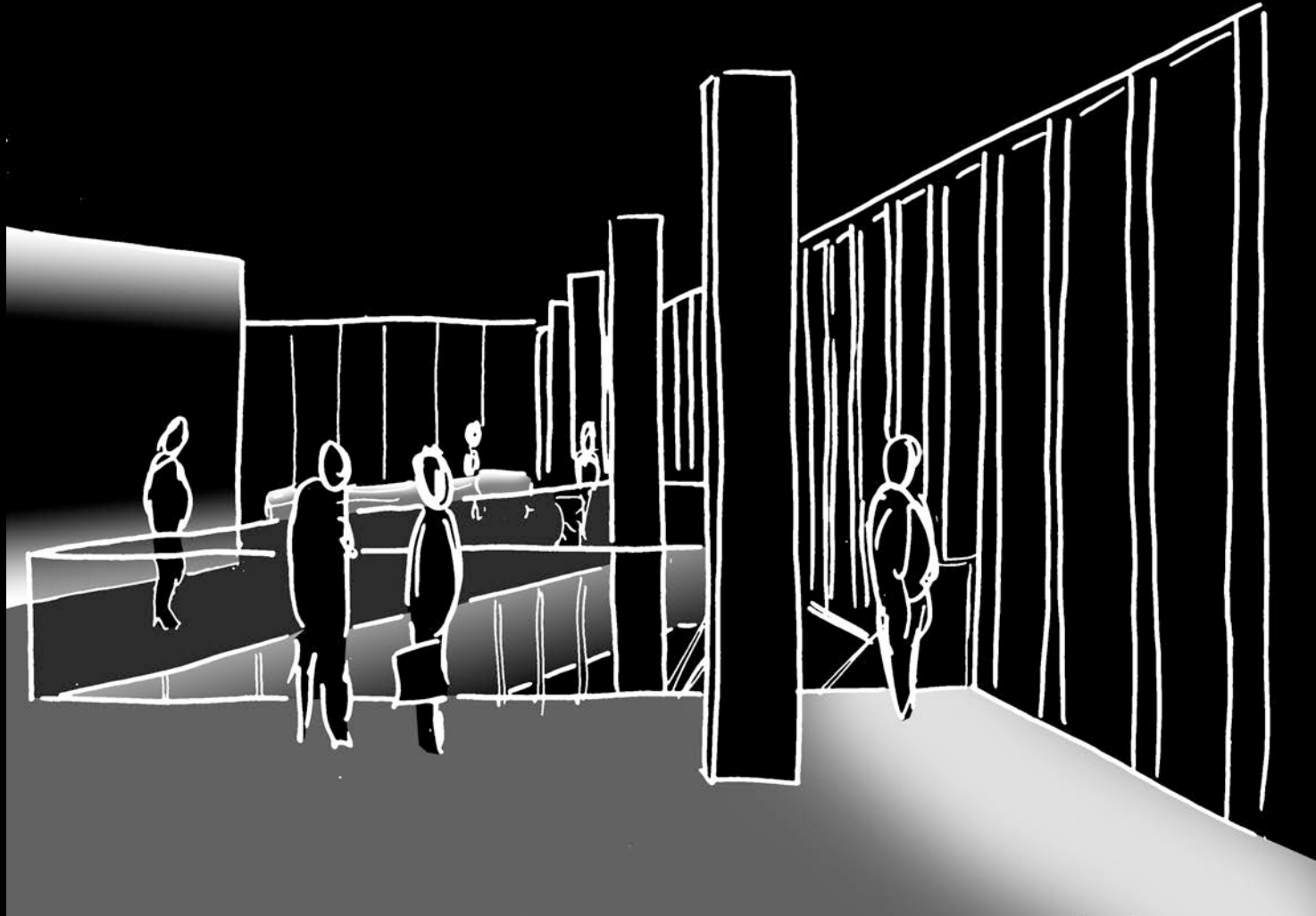

Terrace

Lobby

Shop

Multi-Use

THE CLARK

Building Concept **Spaces**

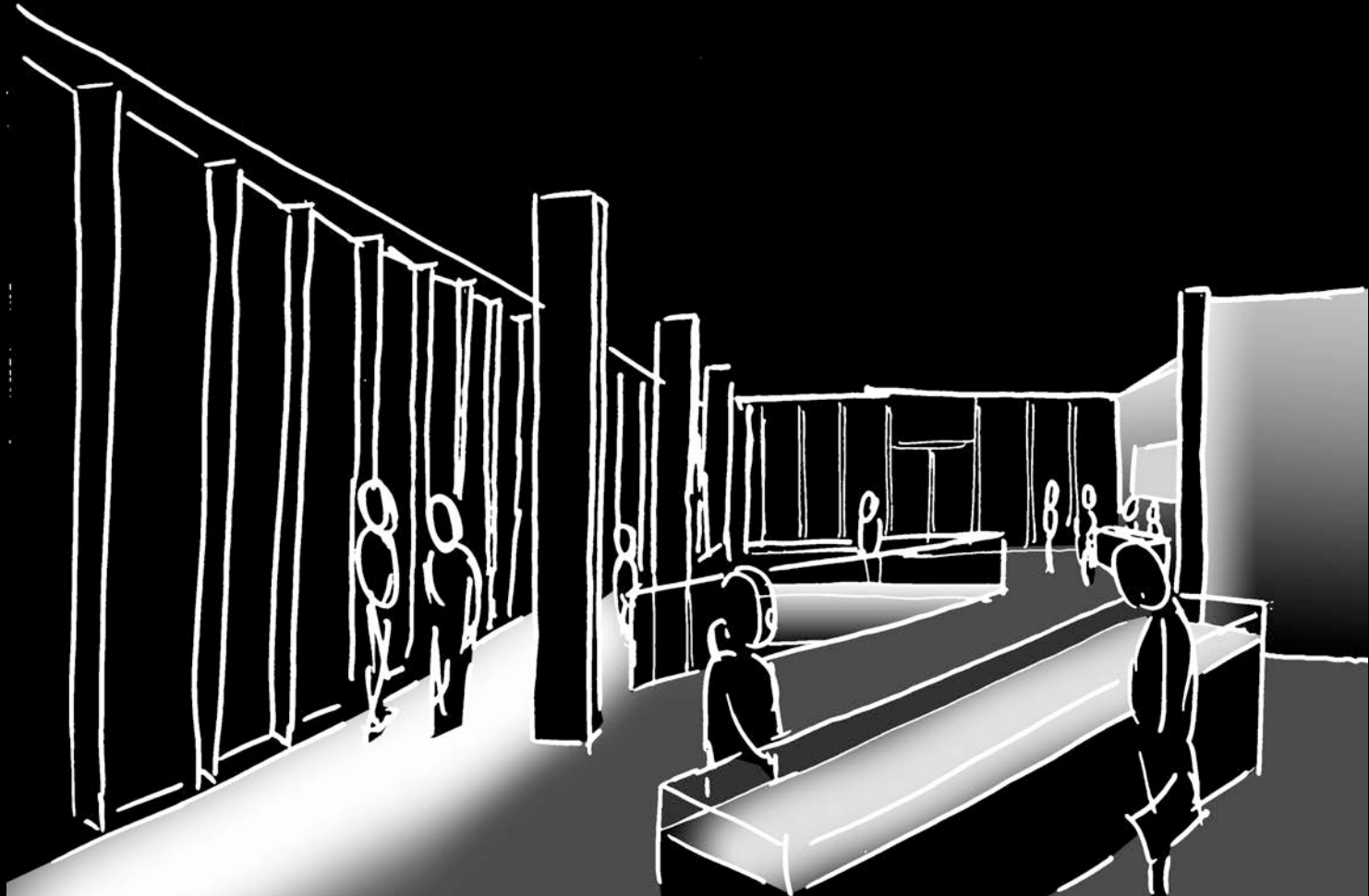

Terrace

Lobby

Shop

Multi-Use

Criteria

- Visual clarity
- Uniform light
- Sufficient color rendering
- Visual clarity
- Uniform light
- Sufficient color rendering

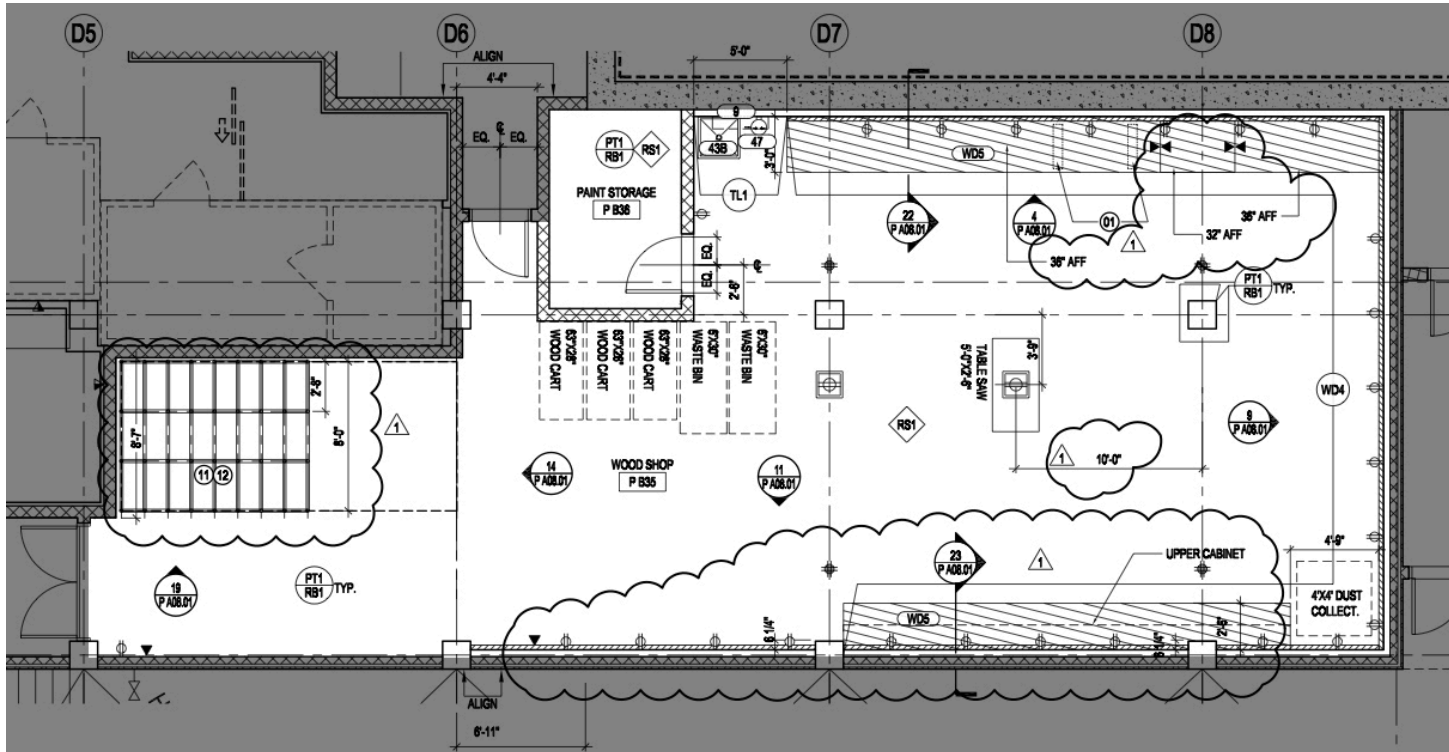

THE CLARK

Building Concept **Spaces**

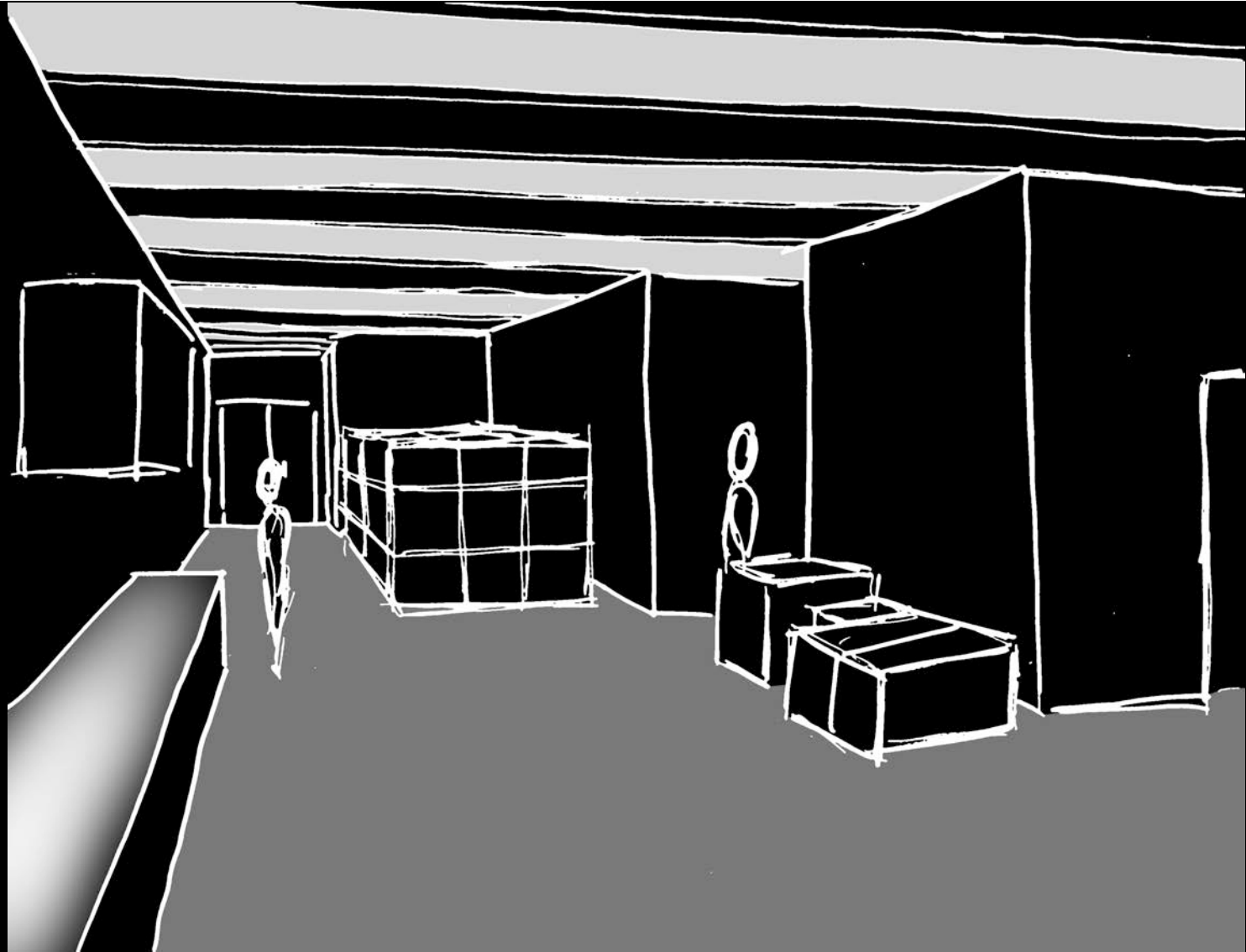

Terrace

Lobby

Shop

Multi-Use

THE CLARK

Building Concept **Spaces**

Criteria

- Showcase artwork appropriately
- Provide adequate illumination for conferences and galas
- Highlight architectural features
- Reduce light trespass
- Reduce skyglow
- Control glare
- Remain consistent to overall design concepts



Terrace Lobby Shop **Multi-Use**

THE CLARK

Building Concept **Spaces**

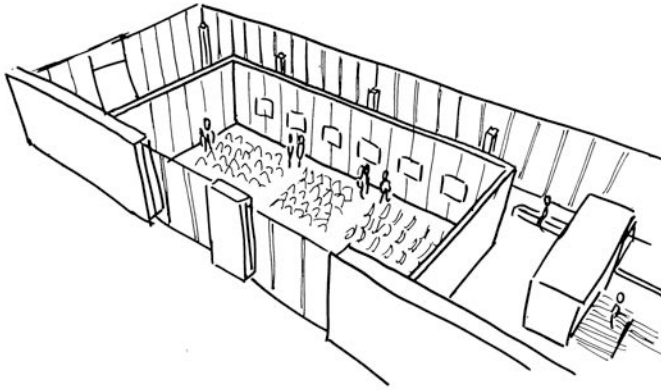

Conference

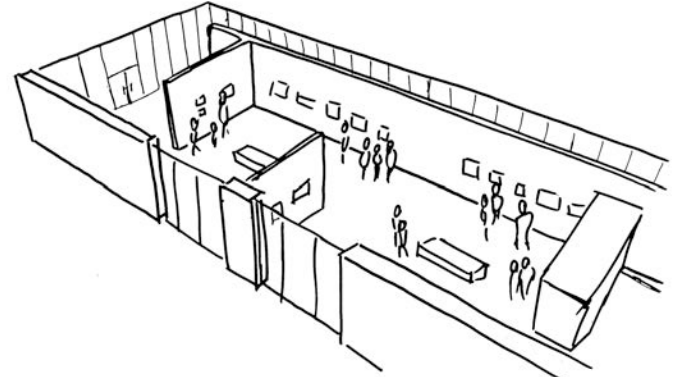

Gallery

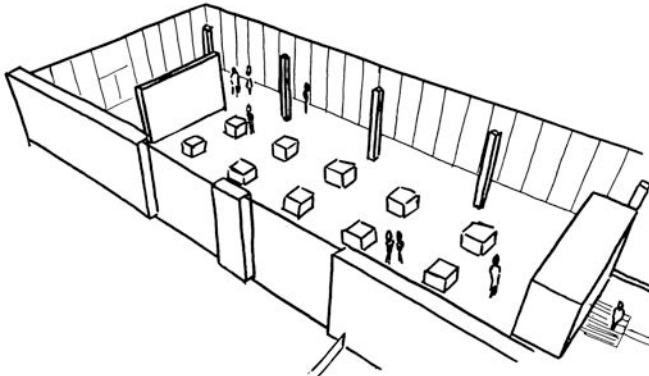

Exhibit



Modular lens track fixture

Terrace Lobby Shop **Multi-Use**

THE CLARK

Building Concept **Spaces**

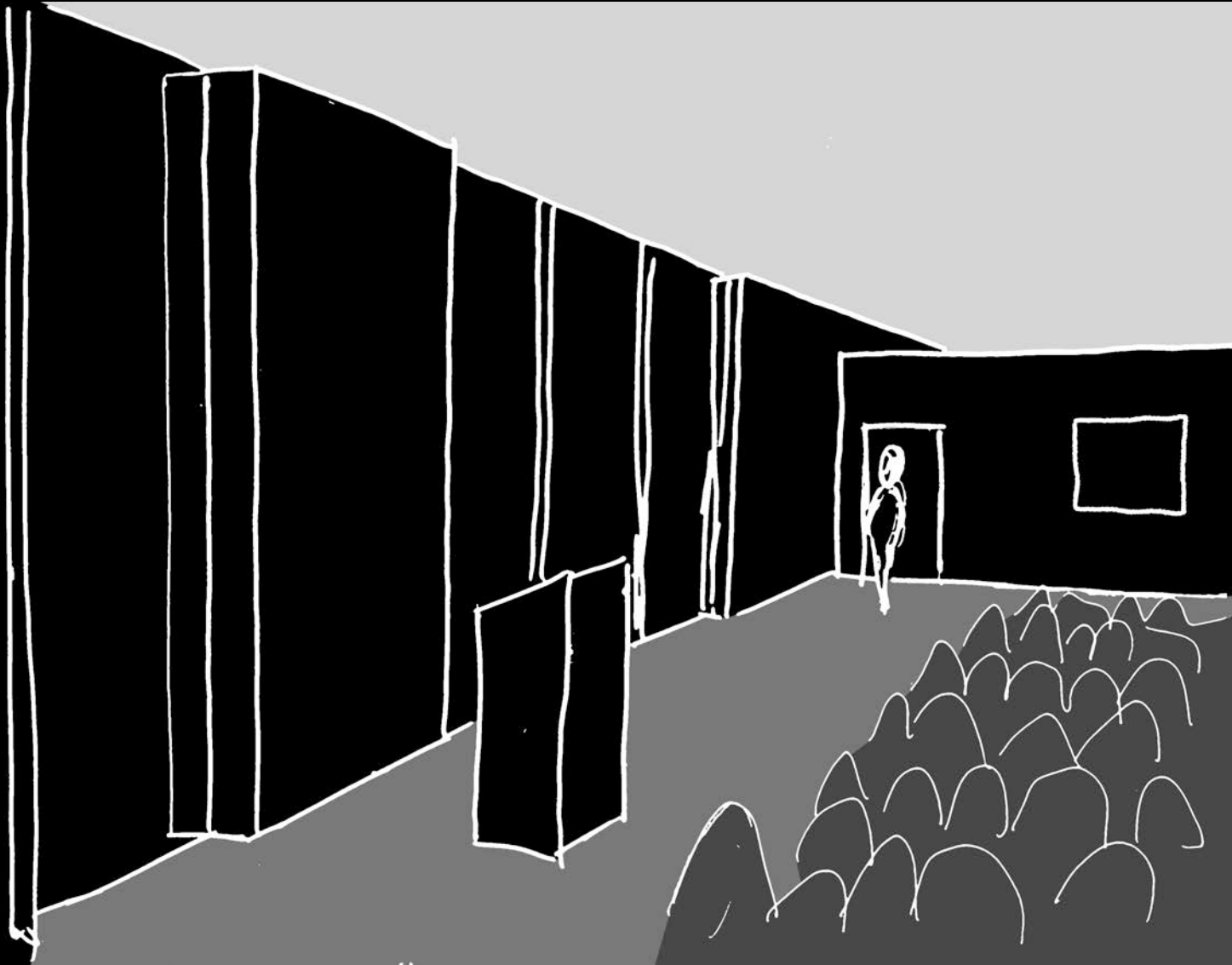

Terrace

Lobby

Shop

Multi-Use

THE CLARK

Building Concept **Spaces**

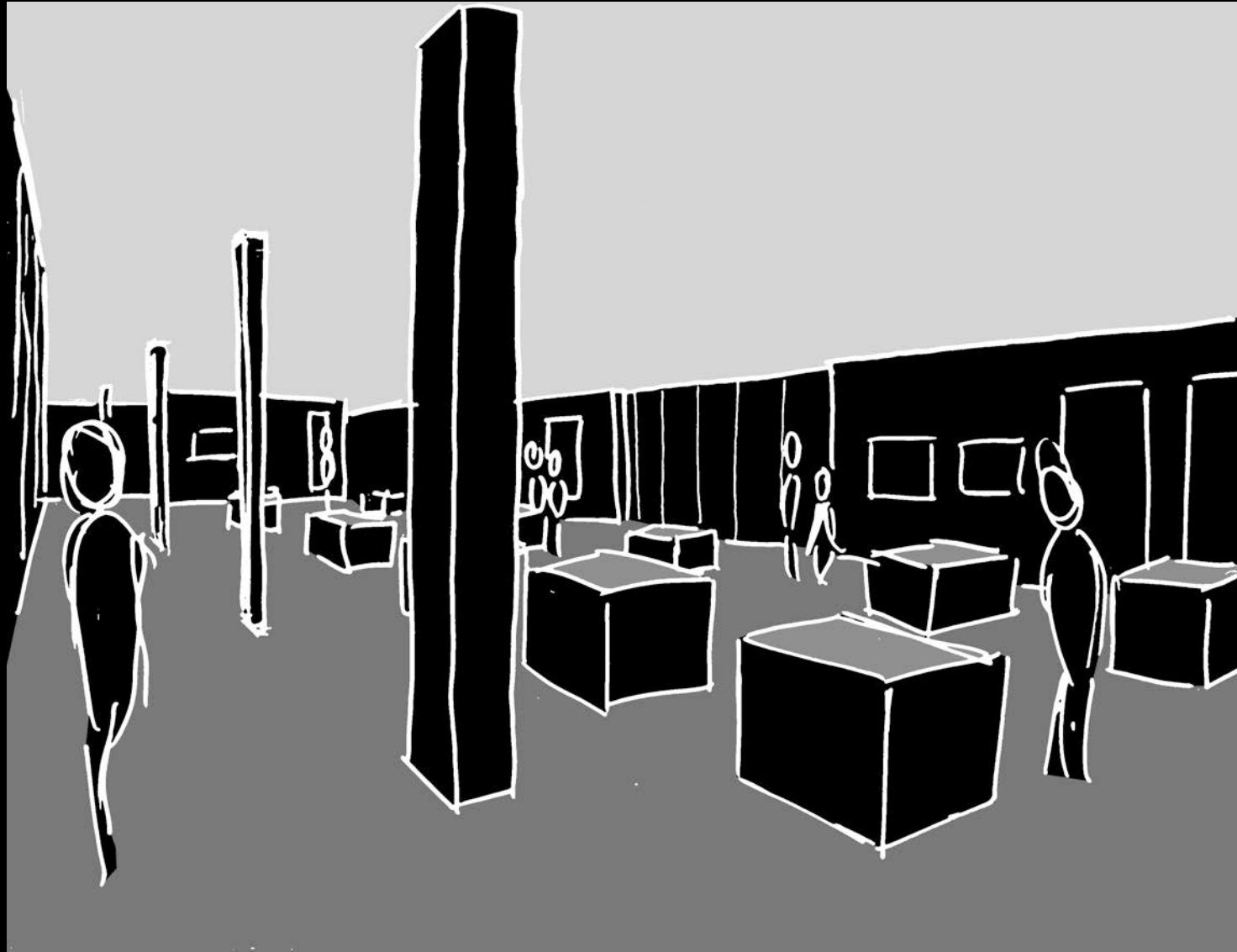

Terrace

Lobby

Shop

Multi-Use

THE CLARK

Building

Concept

Spaces

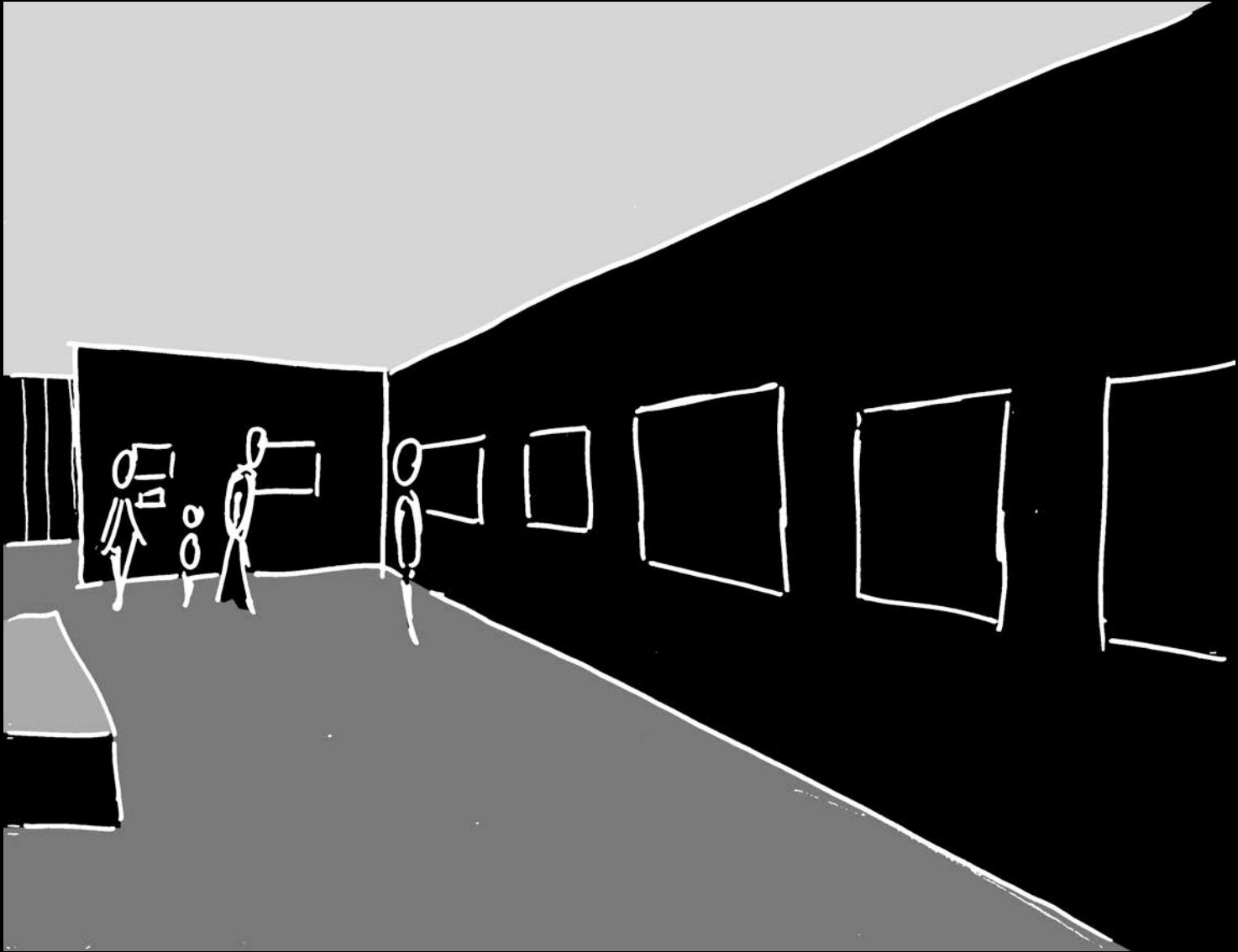

Terrace

Lobby

Shop

Multi-Use

THE CLARK

Building Concept **Spaces**

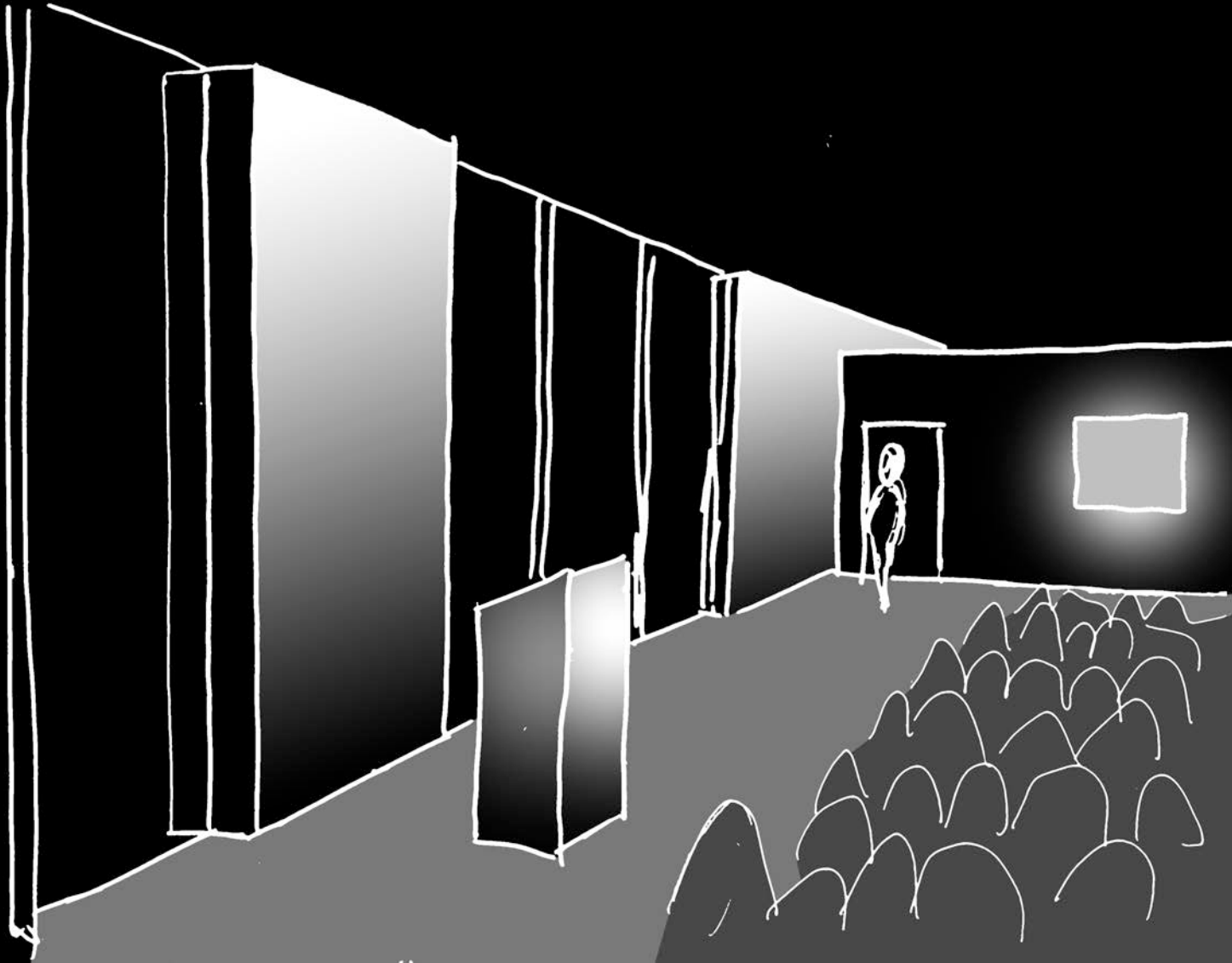

Terrace

Lobby

Shop

Multi-Use

THE CLARK

Building Concept **Spaces**

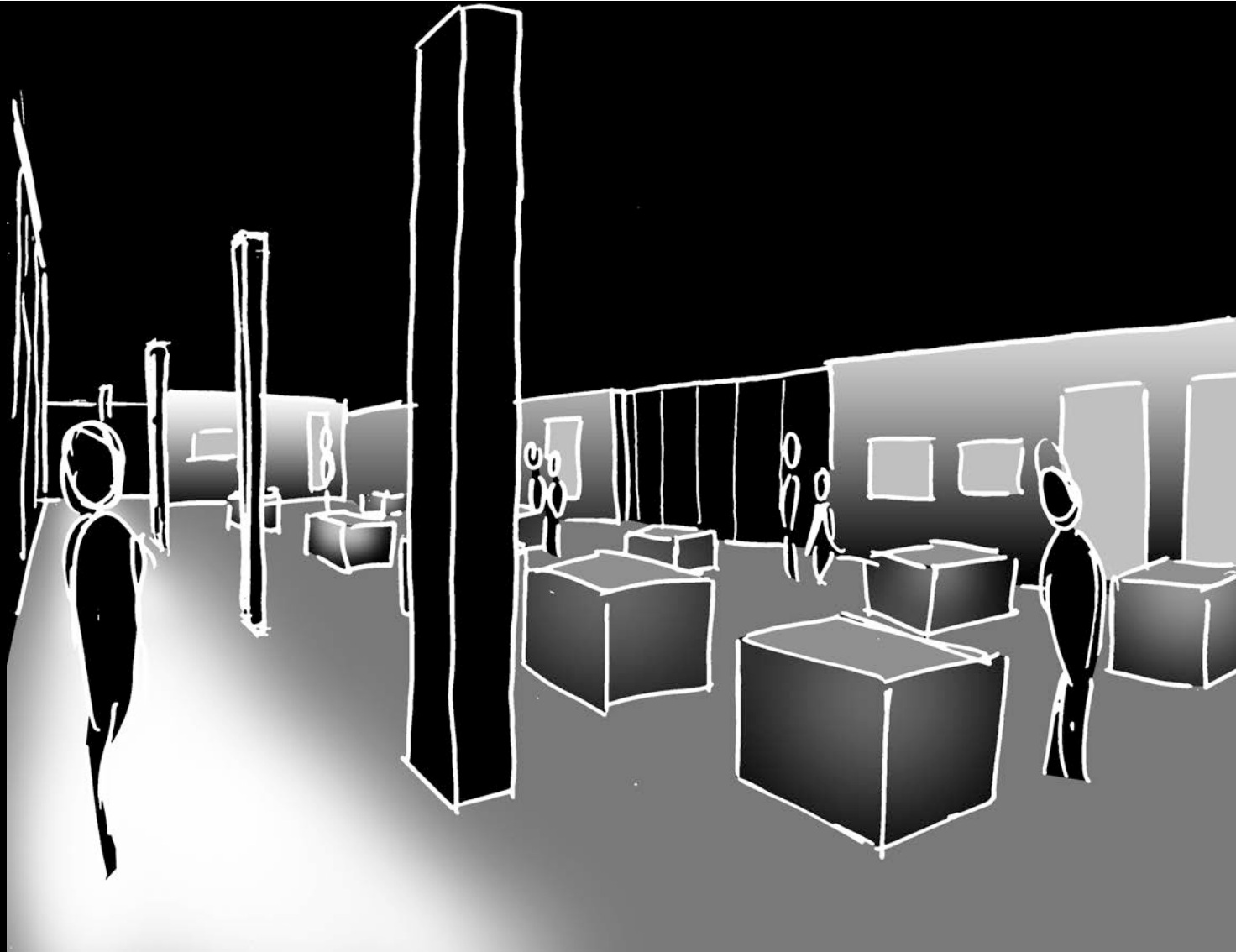

Terrace

Lobby

Shop

Multi-Use

THE CLARK

Building

Concept

Spaces

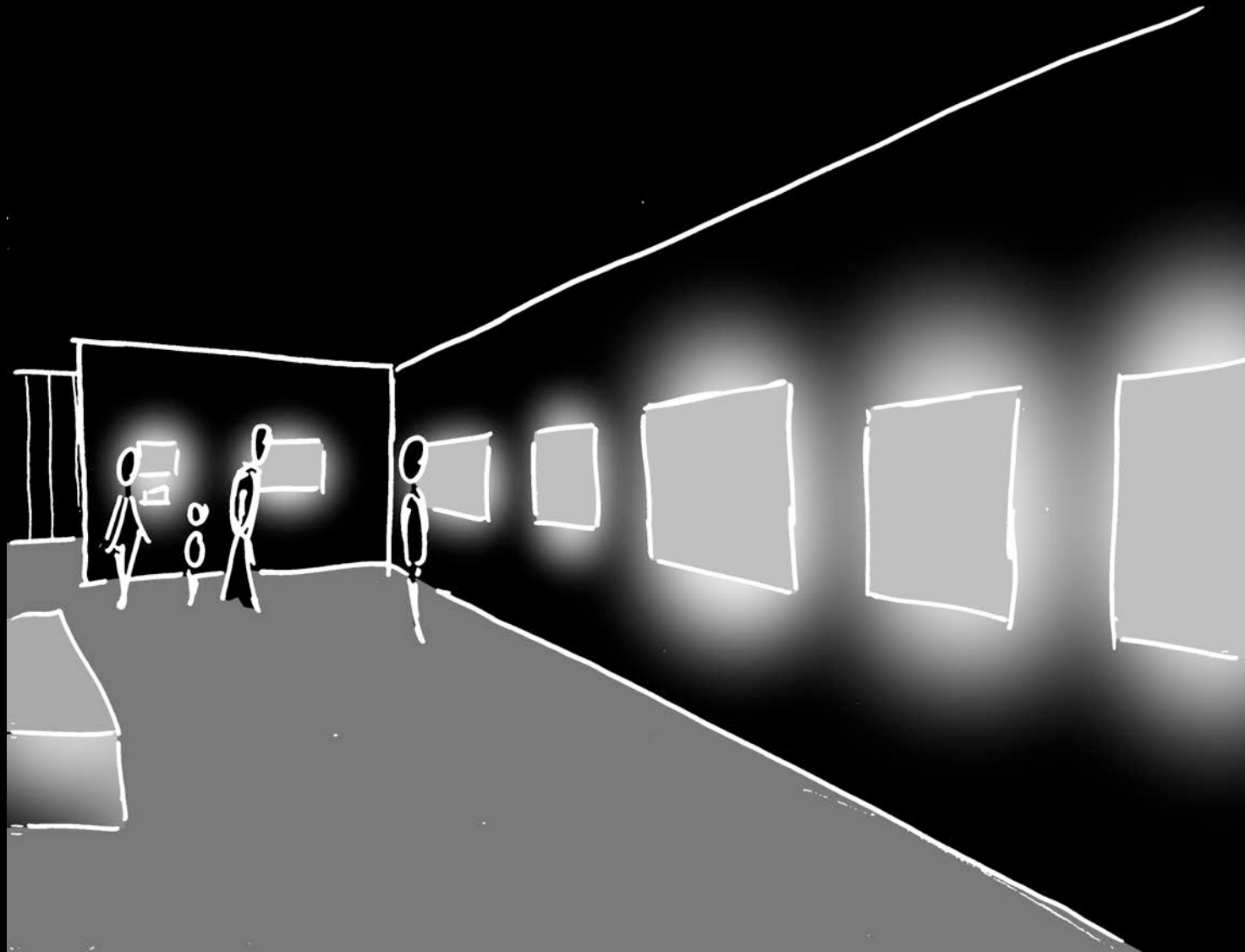

Terrace

Lobby

Shop

Multi-Use

THE CLARK

Building Concept **Spaces**

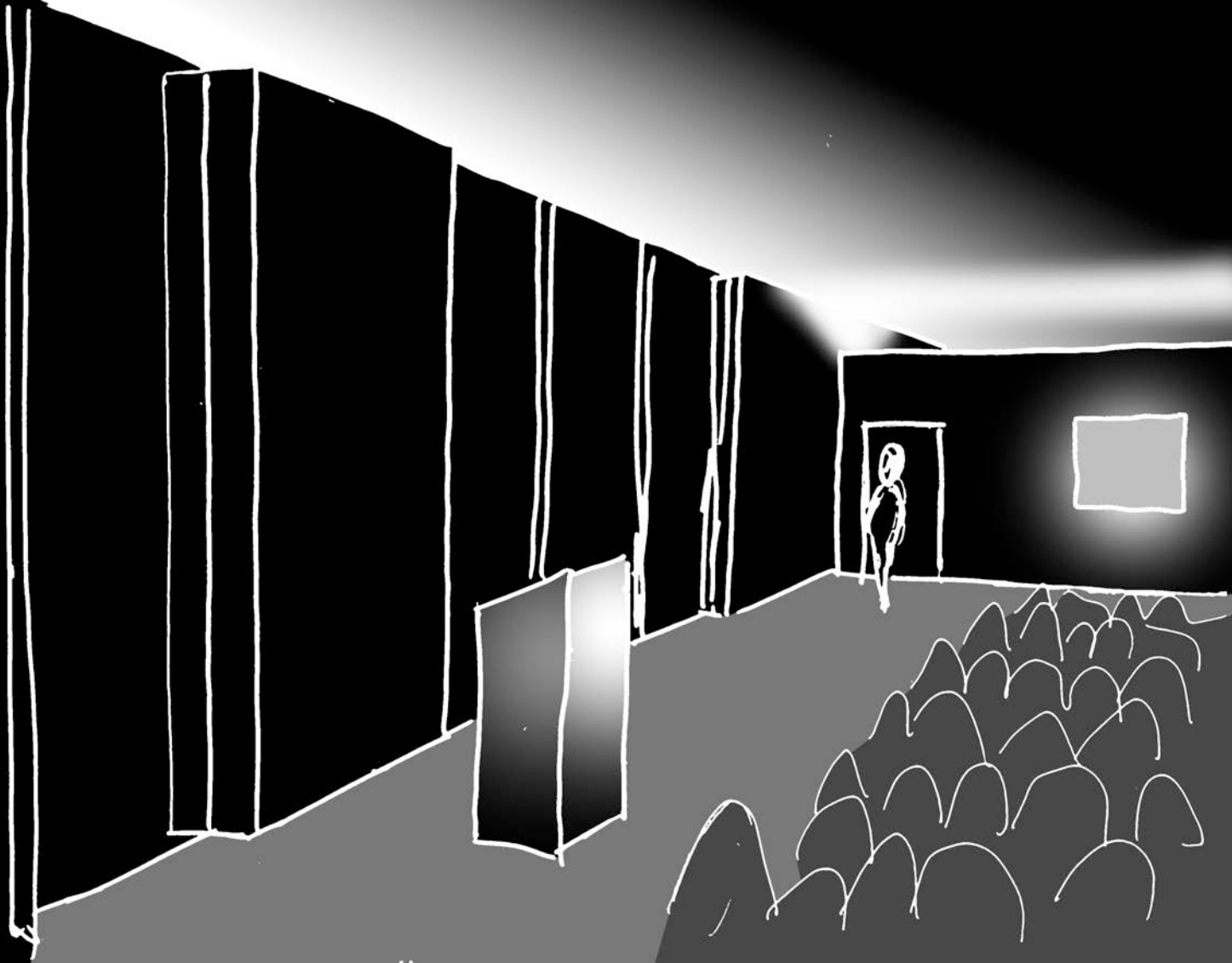

Terrace

Lobby

Shop

Multi-Use

THE CLARK

Building Concept **Spaces**

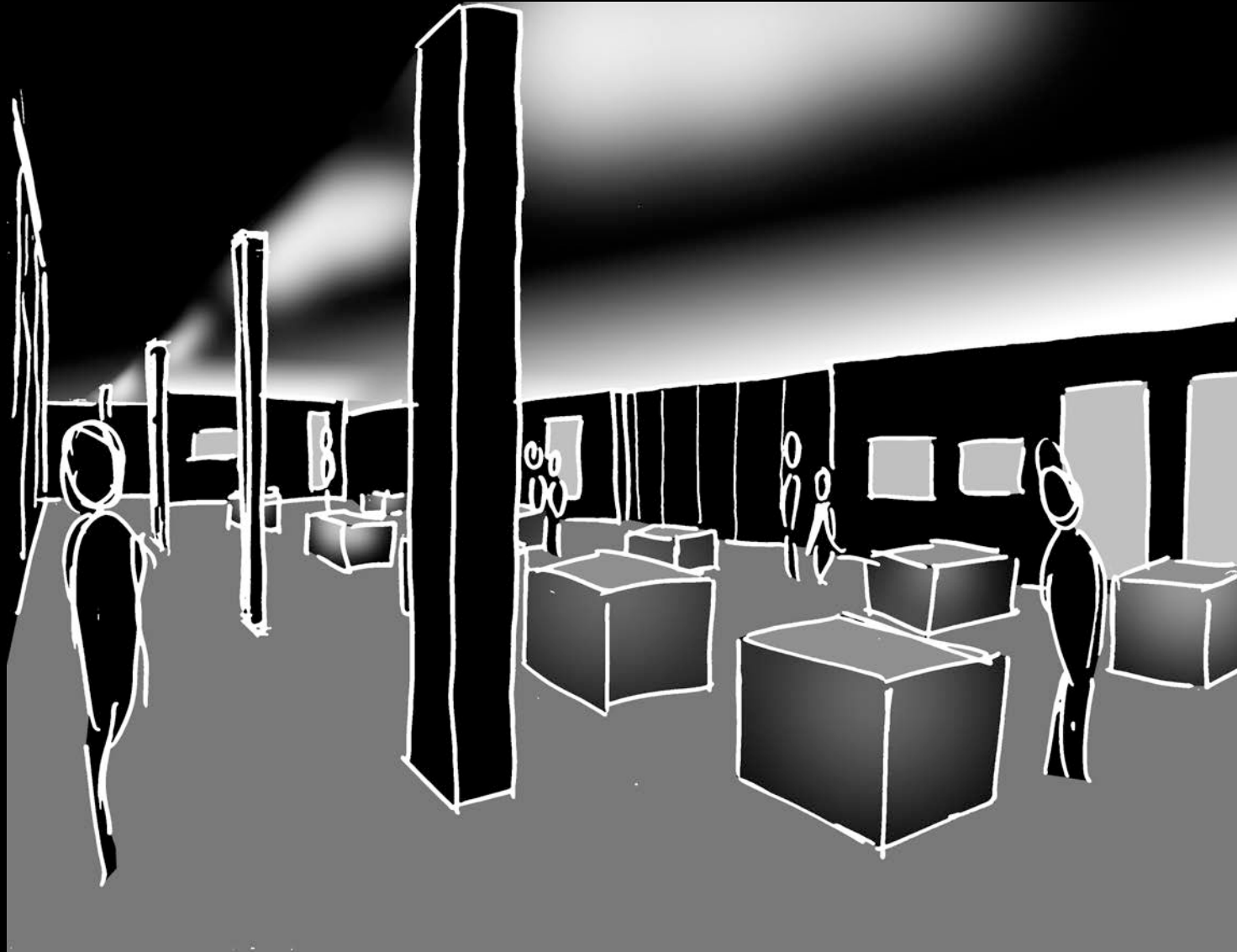

Terrace

Lobby

Shop

Multi-Use

THE CLARK

Building

Concept

Spaces

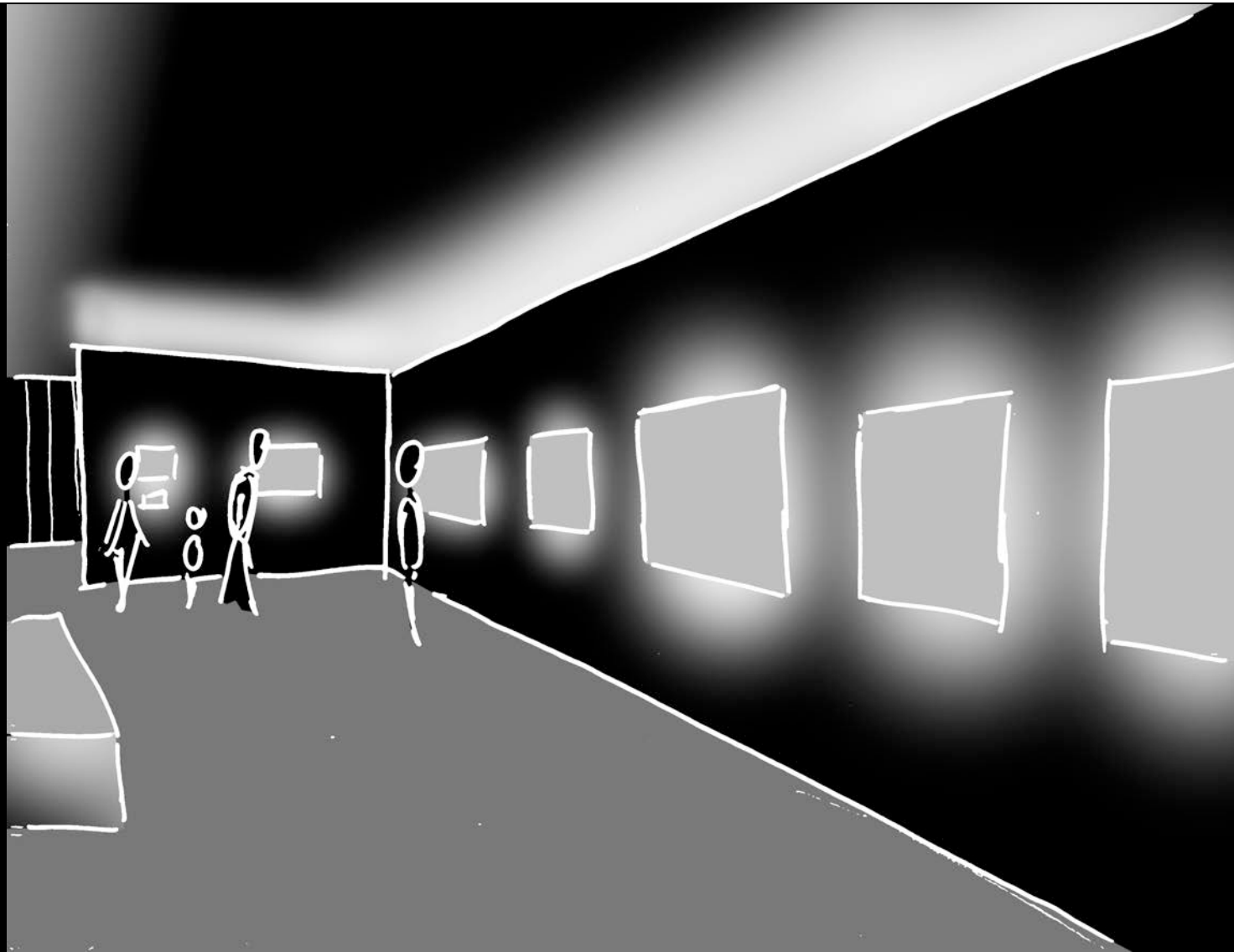

Terrace

Lobby

Shop

Multi-Use

THE CLARK

Building **Concept** Spaces

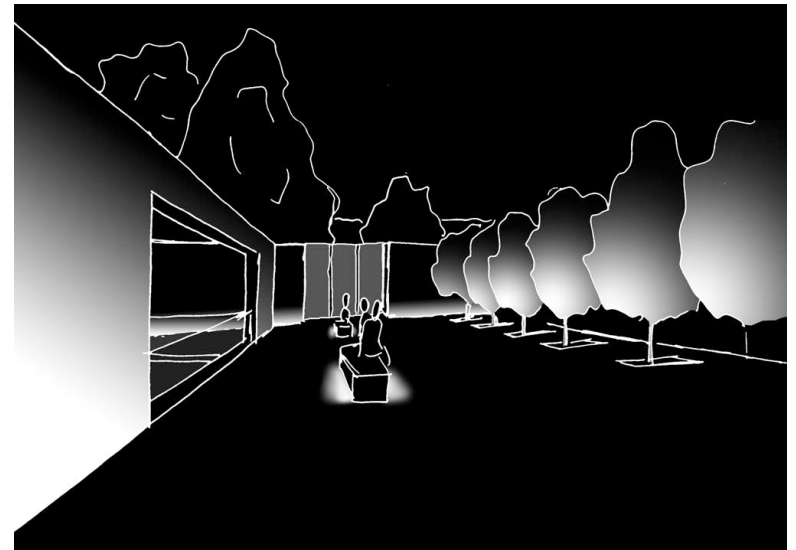
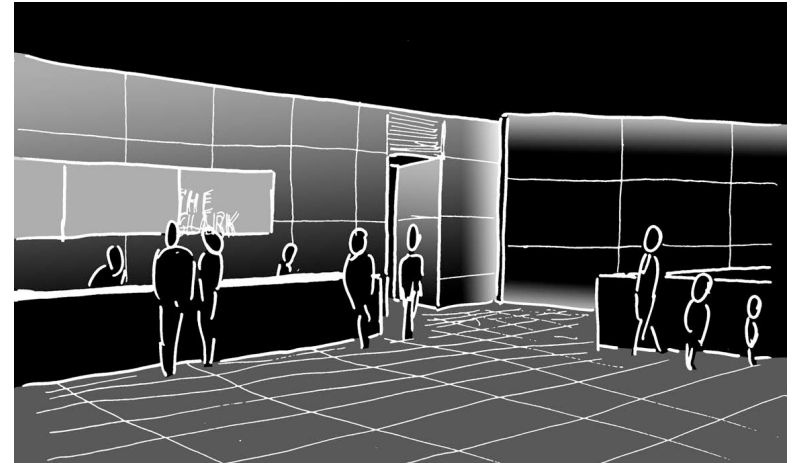

Thank You