

GEORGE READ HALL

UNIVERSITY OF DELAWARE

NEWARK, DE



PROJECT OVERVIEW:

- 5 STORIES
- APPROX. 129,000 SQUARE FEET
- RESIDENTIAL HOUSING FOR STUDENTS
- CONSTRUCTION: MAY 2004-AUGUST 2005
- \$27 MILLION

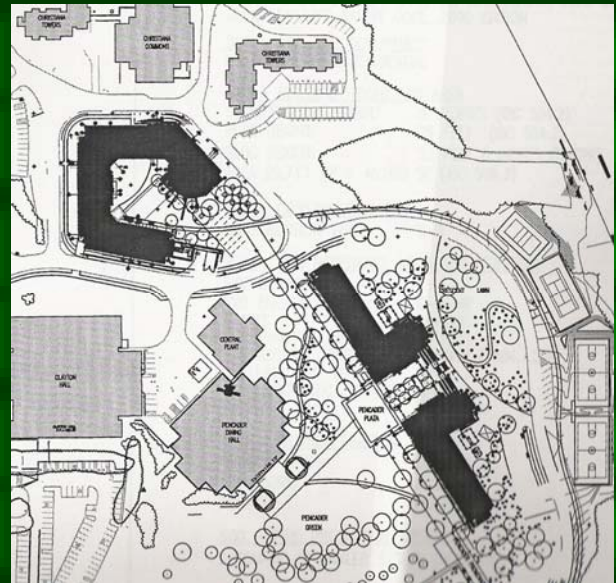

PRIMARY PROJECT TEAM:

OWNER: THE UNIVERSITY OF DELAWARE
ARCHITECT: AYERS/SAINT/GROSS
CONSTRUCTION MANAGER: WHITING-TURNER
STRUCTURAL ENGINEER: SKARDA & ASSOCIATES
CIVIL ENGINEER: TETRA TECH, INC.
CODE CONSULTANT: KOFFEL & ASSOCIATES
M.E.P. AND FIRE PROTECTION: SEBESTA BLOMBERG & ASSOCIATES

ARCHITECTURAL:

- GEORGIAN STYLE
- LARGEST OF THREE BUILDINGS IN NEW RESIDENTIAL COMPLEX
- "U-SHAPED"
- PEDESTRIAN BRIDGE TO MAIN CAMPUS

STRUCTURAL:

FOUNDATION: CONTINUOUS & SPREAD FOOTINGS
SUPERSTRUCTURE: COLD FORMED METAL STUDS
FLOOR: HAMBRO COMPOSITE FLOOR SYSTEM
LATERAL SYSTEM: X-BRACED SHEAR WALLS
ENVELOPE: BRICK OR SIMULATED STONE FAÇADE

MECHANICAL:

- 750 TON CHILLER
- VARIABLE AIR VOLUME UNITS
- 50-5,000 CFM

LIGHTING/ELECTRICAL:

- 480/277V & 208/120V
- 3-PHASE, 4-WIRE
- 350 KW DIESEL GENERATOR BACK-UP
- FLUORESCENT/HID LIGHTING

